

**ANNEX 5**  
**SAMPLE HANDLING FOR TRANSPORT**  
**SUMMARY**

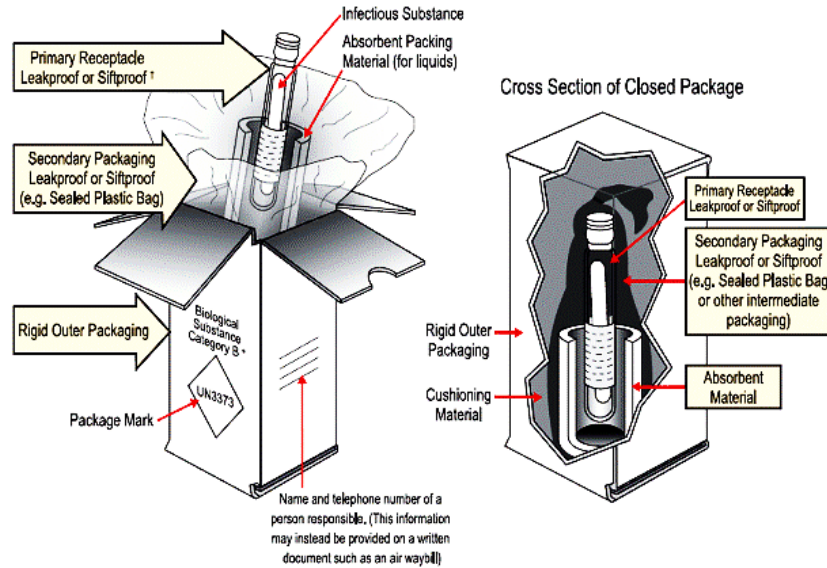

Samples in individual tubes can be placed in a tube rack. Tubes lids should be safely closed.

Rack with tubes should be wrapped in absorbent paper.

The wrapped rack with tubes should be placed in a plastic bag that should be properly closed.

Bag with samples should be preferably packed still frozen, together with at least two frozen coolpacks (see below):

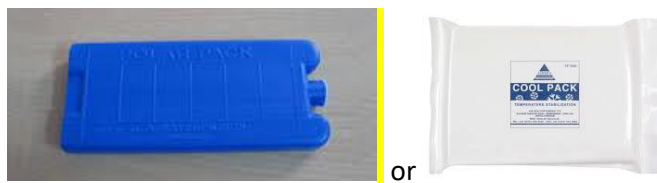

The box for packaging should be preferably of polystyrene, with the following information outside:

- Complete information of consignor
- Complete information of consignee
- Label for Biological substance, Category B (see below):



**BIOLOGICAL SUBSTANCE  
CATEGORY B**